

Plug-in Outlet with Z-Wave Technology

decora smart™



The Plug-In Outlet with Z-Wave Technology (DZPA1) is ideal for any residential setting where remote ON/OFF switching of appliances, motor loads up to 1/2 HP, or freestanding lights, including LED, Incandescent, Inductive Voltage, Fluorescent and Compact Fluorescent loads is needed. Typical applications include switching of lamps, portable fans, kitchen appliances, indoor fountains and more. Also allows users to incorporate small appliances into scene and zone home control applications.

Z-WAVE PLUS CERTIFICATION

- Increased communication range
- Network Wide Inclusion
- Support for beaming and secure commands
- Over The Air (OTA) updates

APPLICATIONS

Schedule your plug-in lamps, holiday lighting or small appliances to turn on/off from anywhere using a compatible Z-Wave® controller. Installation is simple and requires no new wiring – simply plug in the device and pair it with the hub. Features two-way status updating for immediate notification and precise automation scheduling. Reduce energy consumption, provide automated plug-load control based on schedules with a compatible hub, and utilize the wireless affordable plug-in for automating small appliances. The new lighting control accessories are engineered to function with extremely sensitive, low-wattage light sources, such as a single LED bulb in a hallway or a strand of holiday lights, ensuring LEDs do not glow when off. Leviton Z-Wave products make it easy to bring today's technology into your home. For wireless control of lamps, small appliances, holiday lighting and more, Z-Wave Plug-Ins are the smart solution for today's lifestyle.

FEATURES AND BENEFITS

- Transient surge protection to IEC Level 4
- ESD protection to IEC 1000 4-2 Level 4 to protect against damage
- Indoor use
- Green LED locator
- Z-Wave® Plus certified and compatible
- Manual On/Off Control
- Compatible with vizia rf + systems
- Frequency: 908.42 MHz

PLUG-IN APPLIANCE MODULE

- Provides 15A, 120 VAC NEMA 5-15R grounding receptacle for use with a wide variety of lamps and appliances
- Scene and zone control integration
- 2-way status updates
- Protected memory maintains ON/OFF status of loads and during minor power fluctuations
- Button for ON/OFF manual control
- Quiet relay switching

Leviton Manufacturing Co., Inc. Global Headquarters

201 N. Service Rd. Melville, NY 11747-3138 Tech Line: 1-800-824-3005 Fax: 1-800-832-9538

Leviton Manufacturing Co., Inc. Energy Management, Controls and Automation

865 Fulton St., Suite 500, New Orleans, LA, 70130. Tel: 504-608-9001

Visit our Website at: www.leviton.com/decorasmart

©2019 Leviton Manufacturing Co., Inc. All rights reserved. Subject to change without notice.

DRAWING

DZPA1

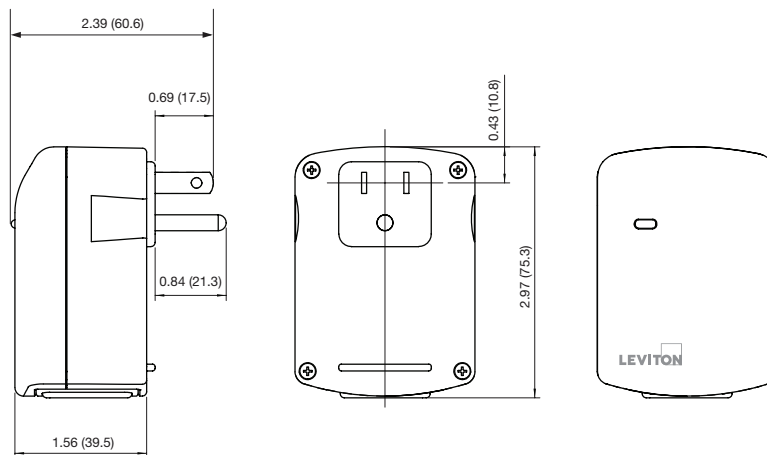

RATINGS

- 120 VAC, 60 Hz
- 1800W Incandescent
- 5A LED/CFL
- 1800VA Fluorescent
- 15A Resistive
- 1/2 HP Motor

INSTALLATION CONSIDERATIONS

Designed for residential applications of up to 7,500 sq. ft.

WARRANTY INFORMATION

- Five-Year Limited Warranty

AGENCY STANDARDS AND COMPLIANCE

- Complies with UL 917
- CSA Certified (File #003413)
- NOM-ANCE Certified
- Complies with FCC Part 15, Class B
- Z-Wave® Certified

ORDERING INFORMATION

DESCRIPTION	CAT. NO.
Plug-In Outlet with Z-Wave Technology - 120VAC 60Hz, Resistive, 1800W, 15A, Incandescent, 1800W, 15A LED/CFL; 5A, Fluorescent, 1800W, 15A, Inductive, 1800VA, 15A, Motor, 1/2HP, 9.8A	DZPA1-2BW

Leviton Manufacturing Co., Inc. Global Headquarters

201 N. Service Rd. Melville, NY 11747-3138 Tech Line: 1-800-824-3005 Fax: 1-800-832-9538

Leviton Manufacturing Co., Inc. Energy Management, Controls and Automation

865 Fulton St., Suite 500, New Orleans, LA, 70130. Tel: 504-608-9001

Visit our Website at: www.leviton.com/decorasmart

©2019 Leviton Manufacturing Co., Inc. All rights reserved. Subject to change without notice.

SAT-10053A
REV OCT 2019