

B Series

Surge Protective Device

Ideal for the branch panel in **COMMERCIAL AND INDUSTRIAL APPLICATIONS** and the main panel in light commercial applications, the B Series is versatile in its usage.



OPTIONAL FLUSH MOUNT FLANGE

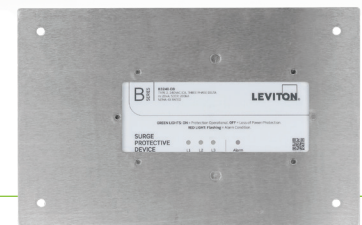

Features

- Maximum Surge Current Rating
65kA per Mode, 130kA per Phase
- UL 1449 Listed
- EMI/RFI Filtering
- Low Voltage Protection Ratings
- 20kA Nominal Discharge Current Rating (I_n)
- 200kA SCCR
- NEMA 4X

Product Specifications

General Specifications	
Maximum Surge Current Rating	65kA per Mode, 130kA per Phase
UL 1449 Type Designation	Type 2
UL 1449 Nominal Discharge Current Rating (I _n)	20kA
UL 1449 Short Circuit Current Rating (SCCR)	200kA
Design Specifications	
Stacked MOV design for High Energy Handling	
Thermally Protected MOVs	
External Parallel Connected for Mounting next to Electrical Gear	
Multi-mode protection	
Diagnostic & Status Monitoring Specifications	
Phase Loss Monitoring	
Audible Alarm	
Form C Dry Contacts, 240V, 2A	
LED Protection Status Monitoring	
GRM (Ground Reference Monitoring), N-G voltage > 20V detected	
Enclosure	
Polycarbonate	
NEMA 4X	
3/4 inch NPT Side Mount Nipple	
Filtering	
Yes, UL 1283	

Standards Compliance & Certifications	
UL 1449 5th Edition: 2021, cULus, (UL File: VZCA.E317603), UL 96A Compliant, ANSI/IEEE C62.41.1-2002, C62.41.2-2002, C62.45-2002, NEC Article 285	
ISO 9001:2014 Quality Management System, ISO 17025:2007 Laboratory Certification (UL DAP Program) Compliance with RoHS, REACH & California Prop 65.	
100% Quality Tested prior to shipping, Country of Origin: Greece	

Physical Specifications					
Humidity Range	0-95% non-condensing				
Operating Frequency	50-60Hz				
Operating Temperature	-40°F(-40°C) to 185°F (+85°C)				
Typical Connection	#12 AWG Type TEW				
UL 1449 Performance Data					
System Voltage	Voltage Protection Rating (VPR)				Maximum Continuous Operating Voltage (MCOV)
	L-N	L-G	N-G	L-L	
120 VAC/CA SINGLE PHASE	700V	700V	700V	-	180V
120/240 VAC/CA SPLIT PHASE	700V	700V	700V	1200V	180V/360V*
208Y/120 3 PHASE WYE	700V	700V	600V	1200V	150V/300V*
480Y/277 VAC/CA 3 PHASE WYE	1200V	1200V	1200V	2500V	350V/700V*
240 VAC/CA 3 PHASE DELTA	-	1000V	-	1200V	275V
480 VAC/CA 3 PHASE DELTA	-	1800V	-	1800V	550V
120/240 VAC/CA, HIGH-LEG DELTA	800V	700V	700V	1500V	180V/275V
600Y/347 VAC/CA, 3 PHASE WYE	1500V	1500V	1500V	3000V	440V/880V*

*Second voltage refers to L-L rating

System Voltage	Voltage Protection Rating (VPR)			Maximum Continuous Operating Voltage (MCOV)
	H-L	H-N	H-G	
120/240 VAC/CA, HIGH-LEG DELTA	1500V	1000V	1000V	275V

Ordering Information

B1120-B	120 VAC/CA, SINGLE PHASE 130kA PER PHASE
B2120-B	120/240 VAC/CA, SPLIT PHASE 130kA PER PHASE
B3120-YB	208Y/120 VAC/CA, THREE PHASE WYE 130kA PER PHASE
B3277-YB	480Y/277 VAC/CA, THREE PHASE WYE 130kA PER PHASE
B3240-DB	240 VAC/CA, THREE PHASE DELTA 130kA PER PHASE
B3480-DB	480 VAC/CA, THREE PHASE DELTA 130kA PER PHASE
B3240-HB	120/240 VAC/CA, HIGH-LEG DELTA 130kA PER PHASE
B3347-YB	600Y/347 VAC/CA, THREE PHASE WYE 130kA PER PHASE

Accessories for Flush Mount Applications

BSURG-FLG B SERIES FLUSH MOUNT FLANGE - ALUMINUM

Wiring Configurations

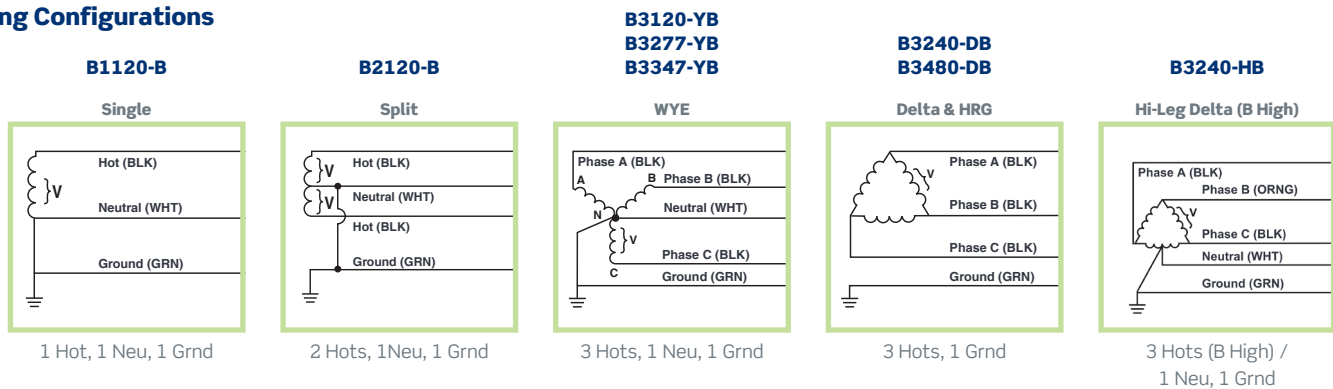

Architectural Drawings (Dimensions)

B SERIES

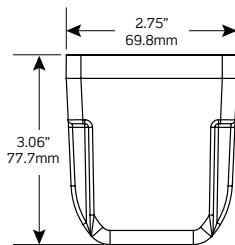
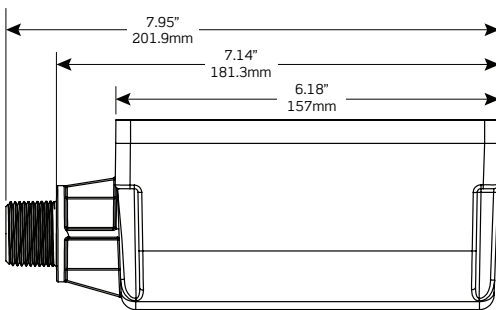
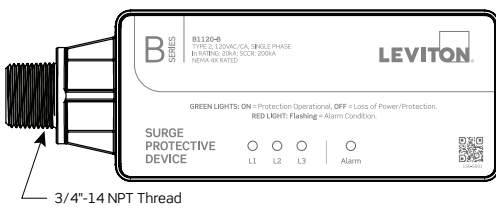

Size and Mechanical Specifications

Dimensions	7.95" x 3.06" x 2.75"
Enclosure Type	Polycarbonate NEMA 4X
Installation Type	Indoor / Outdoor

FLUSH MOUNT FLANGE

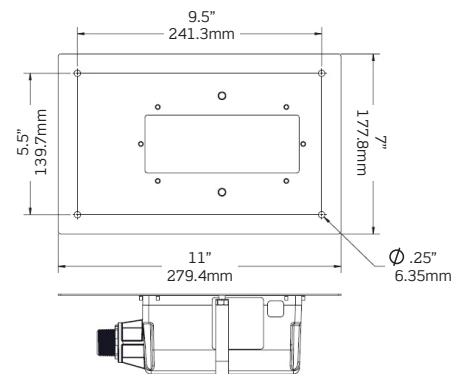

Visit our Website at:
www.leviton.com/surge
 email: commercial@leviton.com
 Q-1505

Leviton Manufacturing Co., Inc.
 201 N Service Rd, Melville, NY 11747
 Telephone: 1-800-323-8920 • FAX: 1-800-832-9538
 Tech Line: 1-800-824-3005 (M-F 8AM-10PM; Sat 9AM-7PM; Sun 9AM-5PM)
 © 2024 Leviton Manufacturing Co., Inc. All rights reserved. 052224

