

# wetguard® Stainless Steel FD Boxes

Designed for use with Wetguard devices!\*

Available in single-gang and two-gang configurations

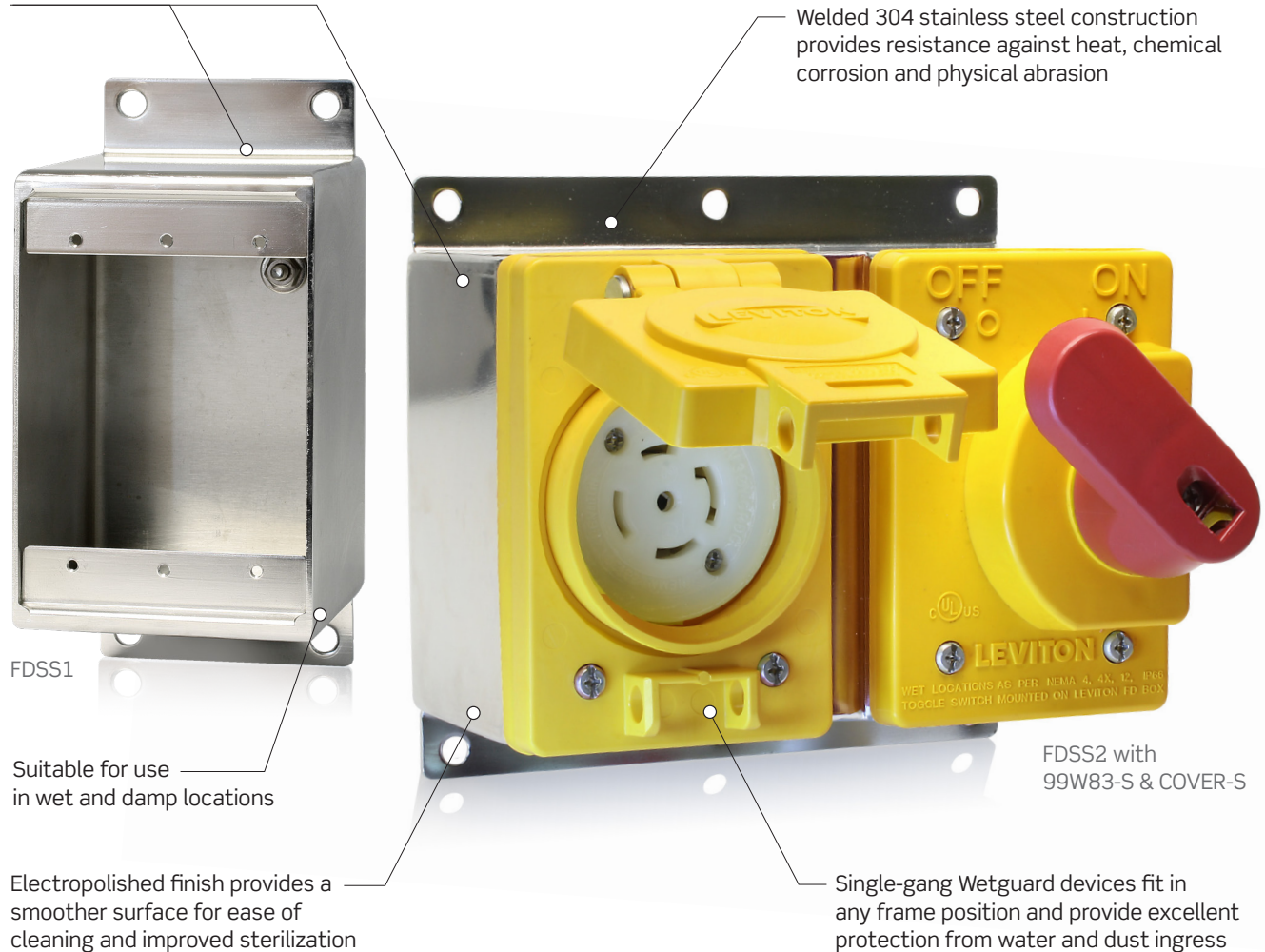

### Common Applications

- Food & Beverage Processing Facilities
- Wastewater Treatment Facilities
- Chemical Processing Plants
- Marinas & Shipyards

### Ordering Information

Description	Catalog Number
Single-Gang Stainless Steel FD Box*	FDSS1
Two-Gang Stainless Steel FD Box*	FDSS2
3/4" Stainless Steel Hub	SSHUB

\* Boxes are compatible with all Wetguard covers EXCEPT duplex receptacle cover.

## Specifications

Description	FDSS1*	FDSS2*
<b>Material Specifications</b>		
Box Material	14 Gauge Type 304 Stainless Steel	
<b>Standards &amp; Certifications</b>		
cULus	UL 514 A	UL 514 A
<b>Box Volume</b>		
Cubic Inches	37.2	87.3
<b>Warranty</b>		
Product Warranty	10 Year	10 Year

\* Boxes are compatible with all Wetguard covers EXCEPT duplex receptacle cover.

## Suggested Wetguard Device Ordering Information

Corrosion Resistant Receptacle, Cover, Gasket	
Catalog #	Description
60W47	15 Amp Flip Lid Cover with Single Receptacle
67W75	20 Amp Flip Lid Cover with Single Locking Flush Mounting Receptacle
67W76	20 Amp Flip Lid Cover with Single Locking Flush Mounting Receptacle
69W76	30 Amp Flip Lid Cover with Single Locking Flush Mounting Receptacle
Commonly Used Wetguard Plugs & Connectors	
Catalog #	Description
14W47 <sup>†</sup>	15 Amp Straight Blade Plug
15W47 <sup>†</sup>	15 Amp Straight Blade Connector with Closure Cap
26W75 <sup>†</sup>	20 Amp Locking Plug
27W75 <sup>†</sup>	20 Amp Locking Connector with Closure Cap
26W76 <sup>†</sup>	20 Amp Locking Plug
27W76 <sup>†</sup>	20 Amp Locking Connector with Closure Cap
28W76 <sup>†</sup>	30 Amp Locking Plug
29W76	30 Amp Locking Connector with Closure Cap
Commonly Used Wetguard Individual Covers	
Catalog #	Description
COVER-S	Single Gang Switch Cover and Gasket for all Single Throw 15 Amp - 40 Amp Toggle Switches, Including Leviton Manual Motor Starters
COVER-GS	Single Gang Switch Cover and Gasket for all Single Throw 15 Amp - 40 Amp Toggle Switches, Including Leviton Manual Motor Starters
60W03 <sup>†</sup>	Wetguard Replacement Cover and Gasket for 20 Amp Locking Box Mount Single Flush Receptacles
60W04 <sup>†</sup>	Wetguard Replacement Cover and Gasket for 30 Amp Locking Box Mount Single Flush Receptacles

<sup>†</sup> Available in black. To order, add "-B" suffix to Catalog #.

## Dimensions

Single-Gang Front View

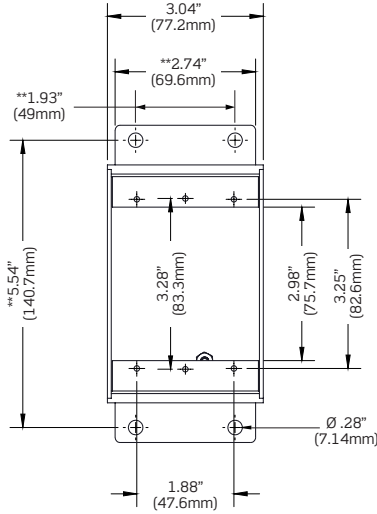

Side View Typical

For Single & Two-Gang

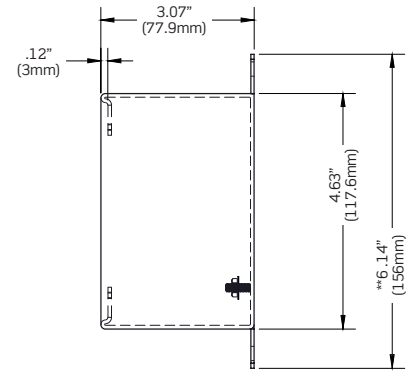

Two-Gang Top View

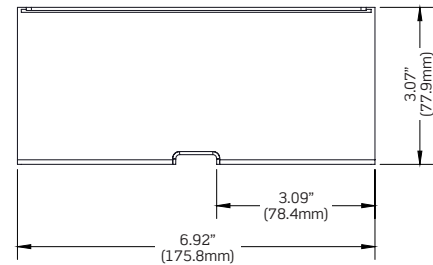

Two-Gang Front View

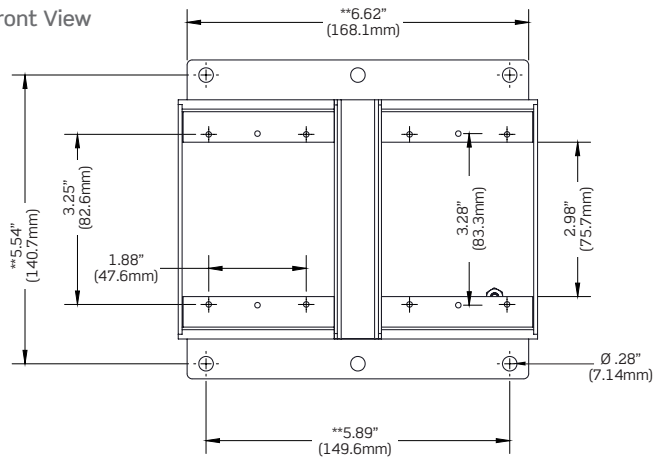

\*\* Dimensions for reference only. Use boxes drilling template. Pre-drilling holes not recommended.

Visit our Website at:  
[leviton.com/wetguard](http://leviton.com/wetguard)  
 email: [industrial@leviton.com](mailto:industrial@leviton.com)  
 Q-982A 022720

### Leviton Manufacturing Co., Inc.

201 N Service Rd, Melville, NY 11747  
 Telephone: 1-800-323-8920 • FAX: 1-800-832-9538  
 Tech Line: 1-800-824-3005 (M-F 8AM-10PM; Sat 9AM-7PM; Sun 9AM-5PM)  
 © 2020 Leviton Manufacturing Co., Inc. All rights reserved.

