

Install divider as shown when installing power and data device in the same box.

For Cat Nos. PTC2F, PT526, PT5FF, and PTC2X.

Notes: Install divider in the angled orientation for PT5FF. All other plates to use the horizontal slots based on the device size accommodation.

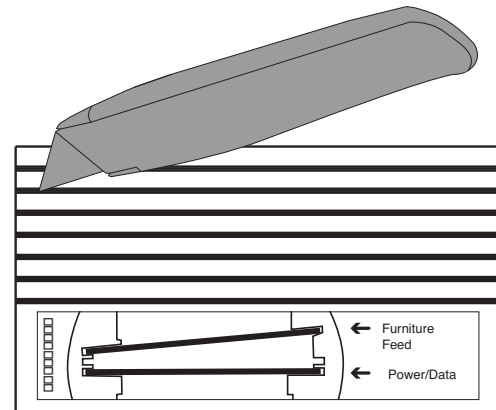

2-Gang Decora Flip Lid Installation

Cat No. PTC2F

1. Remove protective cover.
2. Install 2-Gang Decora flip lid floor cover.
 - Screw tightening torque 4 in-lbs to 6 in-lbs.

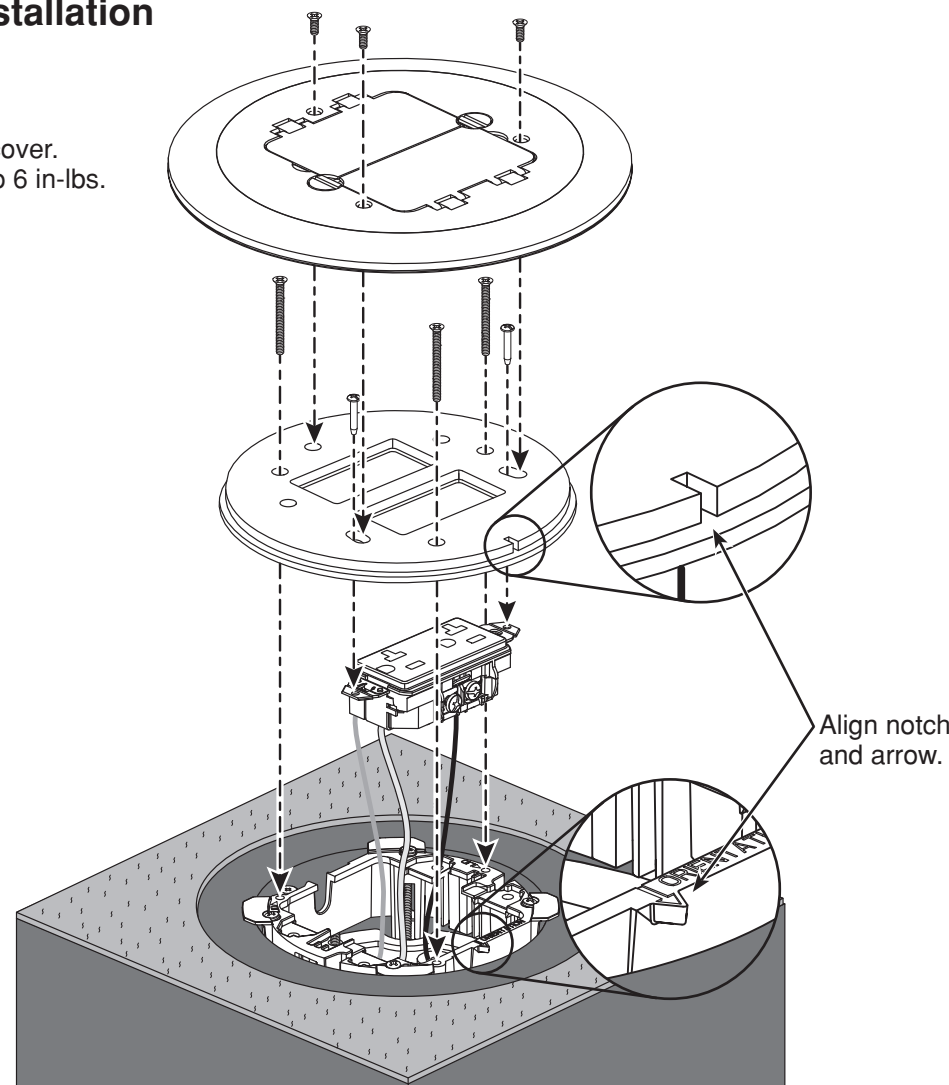

Furniture Feed Floor Cover Installation

Cat No. PT5FF

1. Remove protective cover.
2. Install furniture feed floor cover.
 - Screw tightening torque 4 in-lbs to 6 in-lbs.

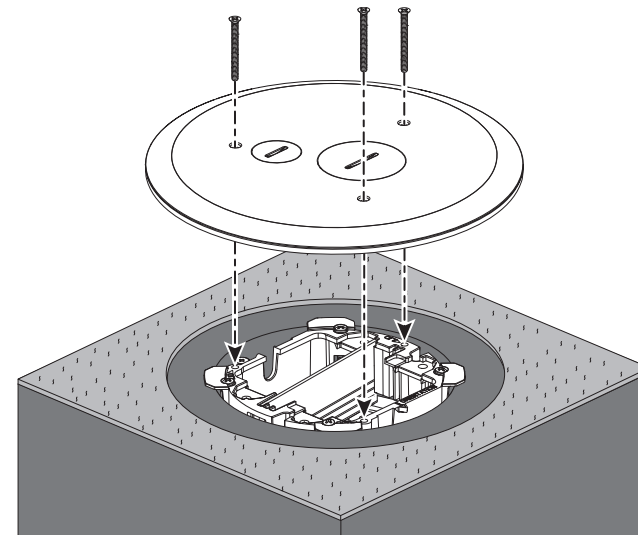

2-Gang Duplex Flip Lid Installation

Cat No. PTC2X

1. Remove protective cover.
2. Install 2-Gang Duplex flip lid floor cover.
 - Screw tightening torque 4 in-lbs to 6 in-lbs.
3. Install Duplex devices to the plate with screws from the bottom as shown below.

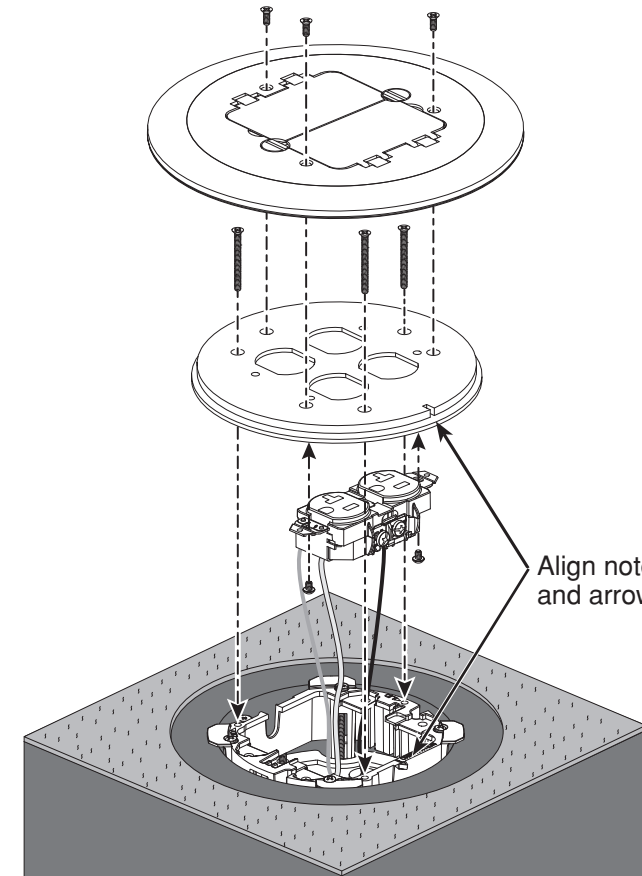

Abandonment Floor Plate Installation

Cat No. PT5AB

1. Remove plate and wiring device. Make sure the exposed ends of the wire don't touch to the cover i.e. insulate the exposed ends of the wire.
2. Install abandonment floor plate.
 - Screw tightening torque 4 in-lbs to 6 in-lbs.

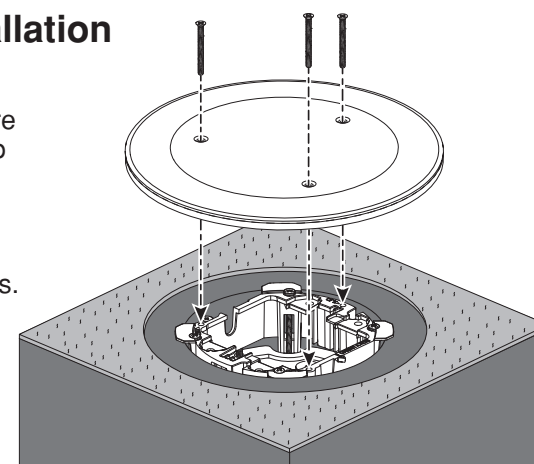

2-Gang Decora Door-in-Door Floor Cover Installation

Cat No. PT526

1. Remove protective cover.
2. Install 2-Gang Decora Door-in-Door floor cover.
 - Screw tightening torque 4 in-lbs to 6 in-lbs.

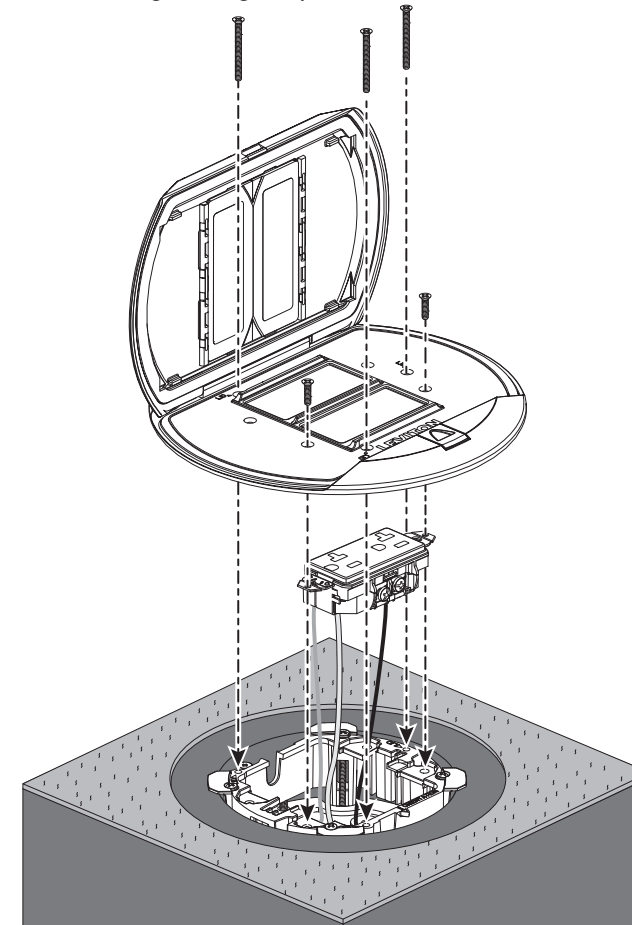

Poke-Through System

Cat. Nos. PT500, PT544, PT526, PTC2F, PT5FF, PTC2X and PT5AB

Ratings: 120/240 V ~ Single Phase 1 or 2 circuits, 20A per circuit

LEVITON®

WARNINGS

TO AVOID FIRE, SHOCK OR DEATH: TURN OFF POWER AT CIRCUIT BREAKER OR FUSE AND TEST THAT THE POWER IS OFF BEFORE WIRING!
 • WHEN THE POKE-THROUGH IS USED IN APPLICATIONS WITH BOTH LINE AND LOW VOLTAGE, DO NOT APPLY POWER UNTIL DEVICES ARE TERMINATED AND DIVIDER IS IN PLACE. **IMPORTANT: ALWAYS ROUTE LOW VOLTAGE WIRING THROUGH CONDUIT PORT LABELED "DATA PORT" IN THE INSTRUCTIONS BELOW.**

- Install and/or use in accordance with appropriate electrical codes and regulations.
- Leviton Poke-Through should only be installed by an electrician.
- Use this device with **copper or copper clad wire only**.

PK-A3337-10-00-5B

INSTALLATION INSTRUCTIONS

ENGLISH

Fire Rating:

Types PT500 Poke-Through fitting, PT5FF, PT526, PT544, PT5AB, PTC2F, or PTC2X covers for use in 1, 1-1/2 or 2 hour fire rated unprotected reinforced concrete floors, in 1, 1-1/2 or 2 hour fire rated floors employing unprotected steel floor units and concrete topping (D900-Series designs) or in 1, 1-1/2 or 2 hour fire rated concrete floor boxes with suspended ceilings. Fire resistive designs with suspended ceilings should have provisions for accessibility in the ceiling area below the Poke-Through fittings.

The assembled Poke-Through fittings will not reduce the ratings of the floor assembly when the thickness and type of concrete (required for the specific rating) are within the specified limits and when the fitting is installed as specified.

1. Concrete - Minimum 2-1/4 in. thickness of structural concrete topping over metal deck or a minimum 3 in. thick reinforced concrete slab. Unit weight of concrete to be 105 to 155 pcf.
2. Installation - Mounted in a 5 in. diameter core-drilled hole in concrete. For use with power circuits, data and/or audio/visual cables. The maximum allowable cross-sectional area of copper for power or communications cabling in each Poke-Through electrical insert is shown below. Cross-sectional area of commonly-used solid copper conductors in power cable is 0.0051 sq. in. for No. 24 AWG and 0.0040 sq. in. for No.23 AWG. Cross-sectional area of commonly -used solid copper conductors in power cable is 0.0051 sq. in. for No. 12 AWG.
3. Spacing - Minimum of 2' [610mm] OC and not more than one unit per 65 sq. ft. [6 sq. m] of floor area in each span.

Poke-Through Kit

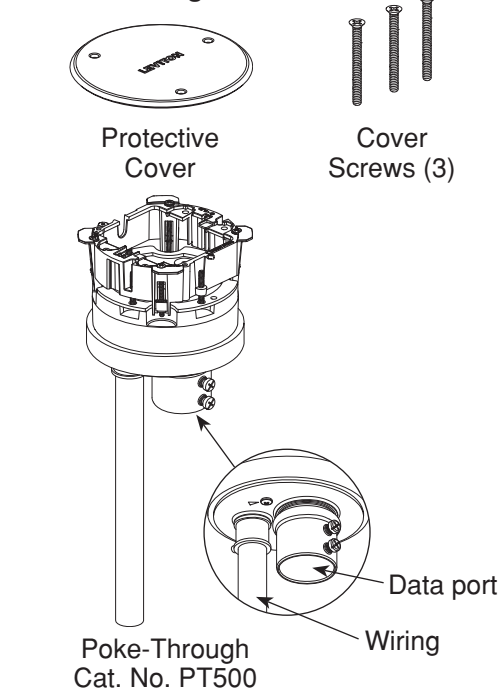

Cover Kits (each sold separately)

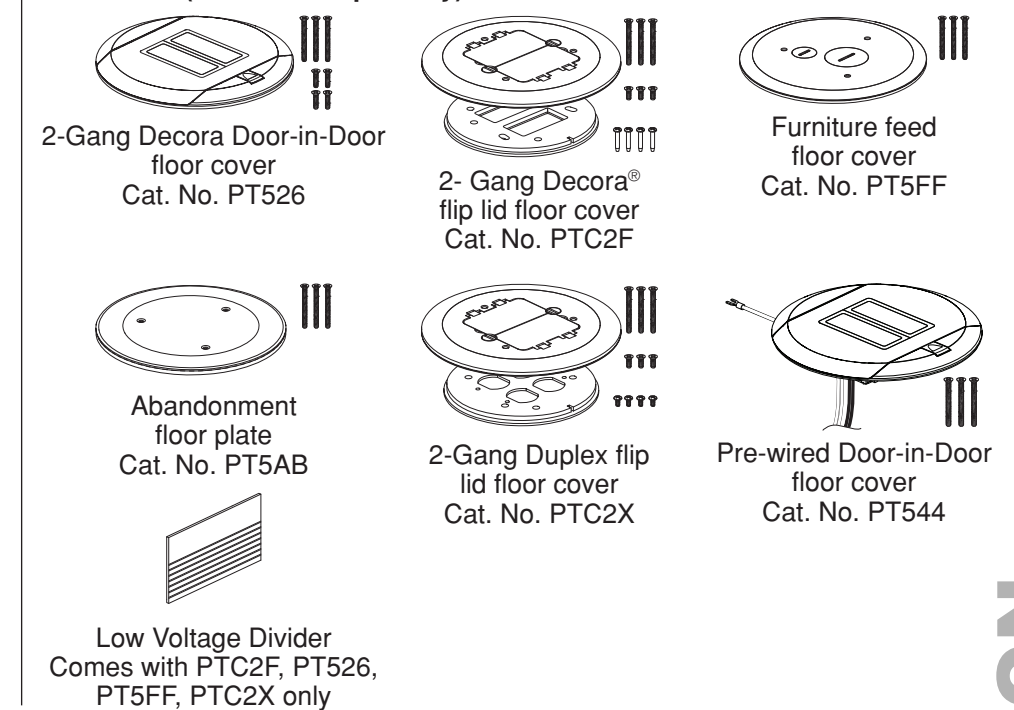

Maximum permitted wires and cables for PT5FF			
12 AWG Wire		Cat 6 Cables (23 AWG)	
Number	Area (sq. in.)	Number	Area (sq. in.)
16 Plus Ground	0.0867	18	0.0576

Note: The maximum allowable cross-sectional area of copper for power or communications cabling in each Poke-Through electrical insert is 0.1443 sq in.

Maximum permitted wires and cables for PT544			
12 AWG Wire		Cat 6 Cables (23 AWG)	
Number	Area (sq. in.)	Number	Area (sq. in.)
5	0.0255	4	0.0128

Maximum permitted wires and cables for PT526, PTC2F, PTC2X			
12 AWG Wire		Cat 6 Cables (23 AWG)	
Number	Area (sq. in.)	Number	Area (sq. in.)
7	0.0357	0	0
4	0.0204	6	0.0192

Note: The maximum allowable cross-sectional area of copper for power or communications cabling in each Poke-Through electrical insert is 0.0396 sq in.

Floor type:

Floor structure - Concrete.
 Floor finishes - Carpet, Polished/Painted Concrete, Vinyl, Terrazzo, Tile, and Wood.

TRADEMARK STATEMENT

Decora is a registered trademark of Leviton Mfg. Co., Inc. and is registered in the United States, Mexico, China, and Canada.

FOR CANADA ONLY

For warranty information and/or product returns, residents of Canada should contact Leviton in writing at **Leviton Manufacturing of Canada ULC** to the attention of the **Quality Assurance Department, 165 Hymus Blvd, Pointe-Claire (Quebec), Canada H9R 1E9** or by telephone at **1 800 405-5320**.

LIMITED 5 YEAR PRODUCT WARRANTY

For Leviton's limited 5 year product warranty, go to www.leviton.com. For a printed copy of the warranty you may call 1-800-323-8920 or write to Leviton Manufacturing Co., Inc., Attn: Customer Service Dept., 201 North Service Road, Melville, New York 11747.

© 2020 Leviton Mfg. Co., Inc.

Poke-Through Installation

1. Before you install.
 - Core a 5 inch hole in floor substrate.

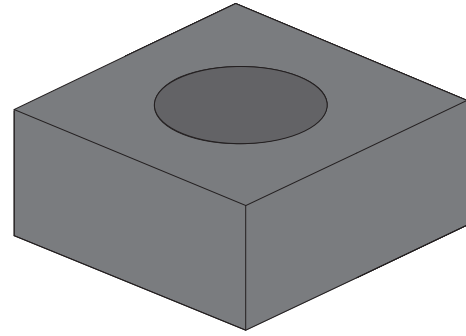

2. Install.
 - Pull wires up through conduit and push poke-through into hole.
 - Tighten flange mounting screws to 8 in-lbs to 12 in-lbs.

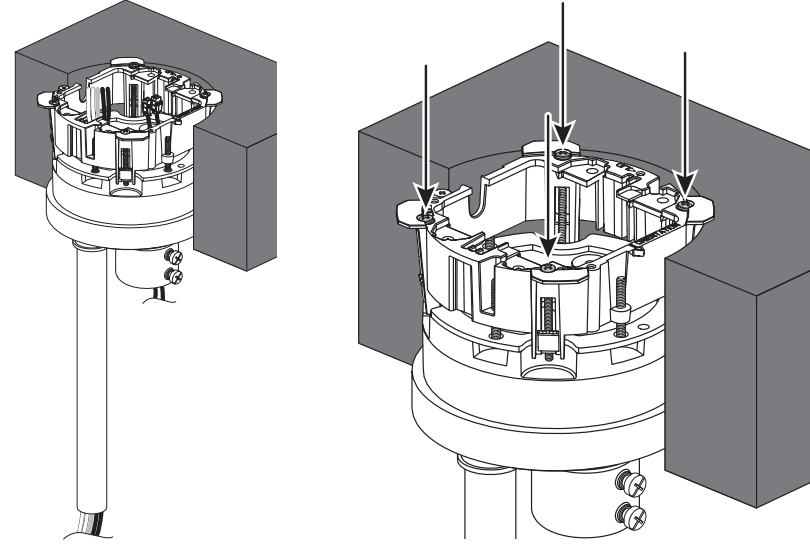

3. Seat poke-through.
 - Push down on the floor of the fire block to ensure it is seated.

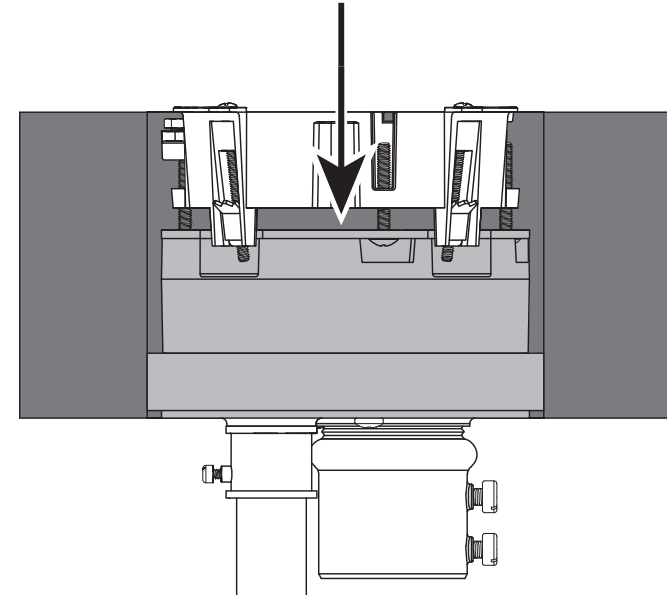

4. Attach protective cover.
 - Use cover screws provided. Tighten to 6 in-lbs.

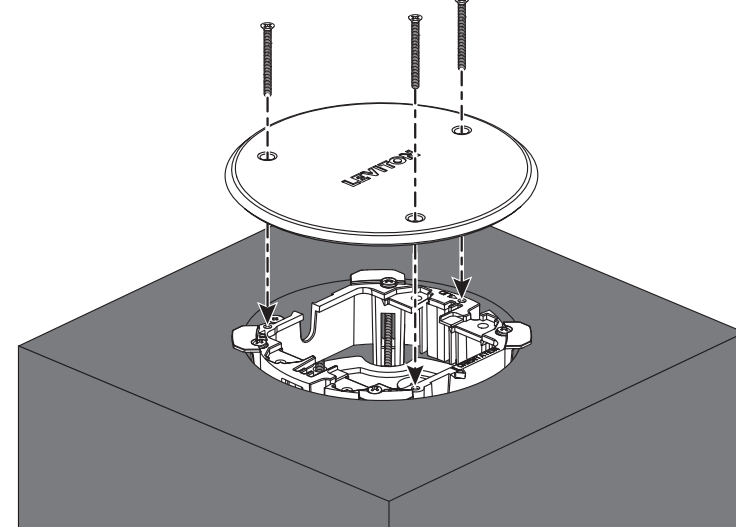

5. Install flooring (optional).

Notes: Can accommodate floor coverings up to 0.75 inches thick. Install junction box at the bottom on the power conduit per local code requirements. Do not remove insulation from the data or power port openings.

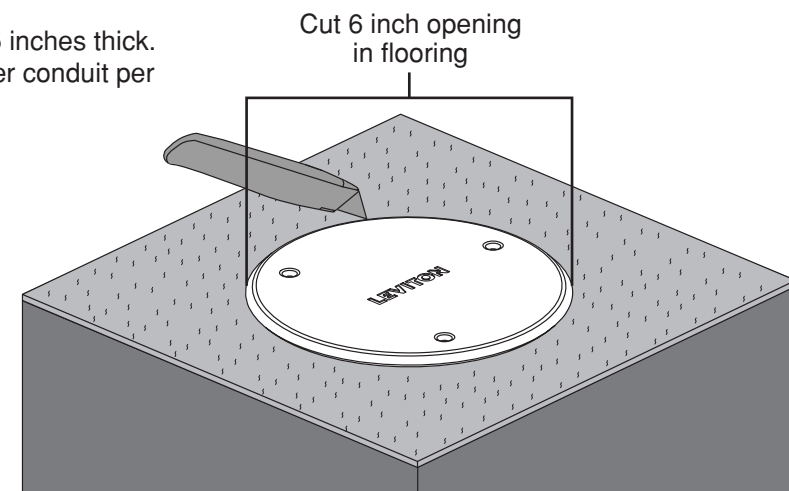

Pre-Wired Door-in-Door Floor Cover Installation

Cat No. PT544

1. Remove protective cover.

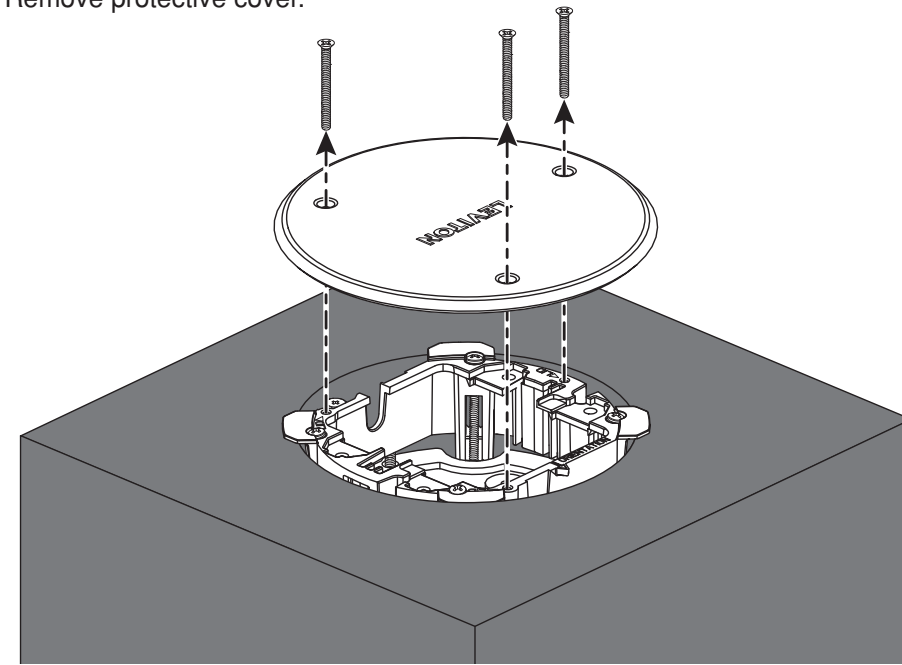

2. Pull data cable through data port and connect to communication data port.

Note: Data ports are compatible with Leviton jacks only.

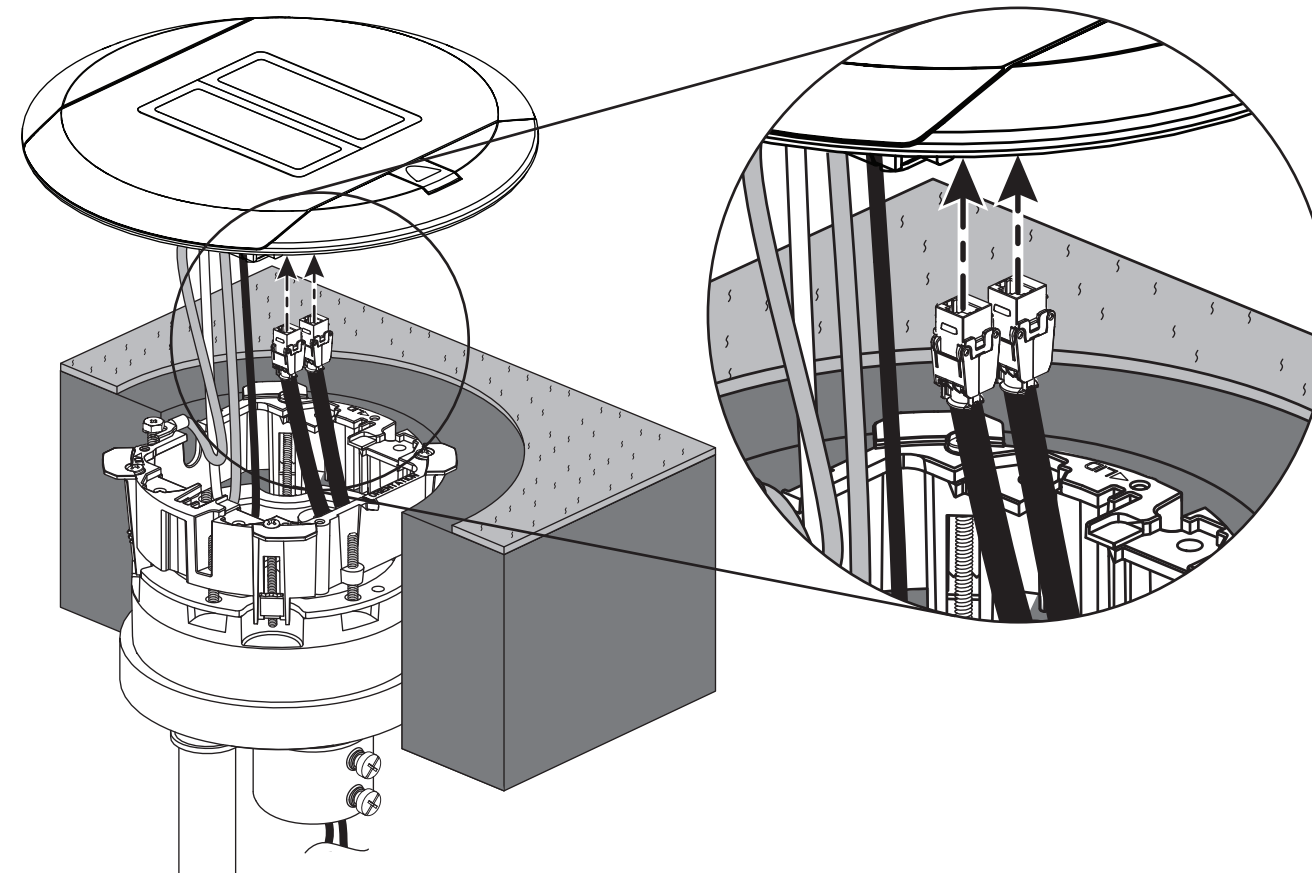

3. Install pre-wired Door-in-Door floor cover.
 - Remove ground wire from PT500.
 - Screw tightening torque 4 in-lbs to 6 in-lbs.

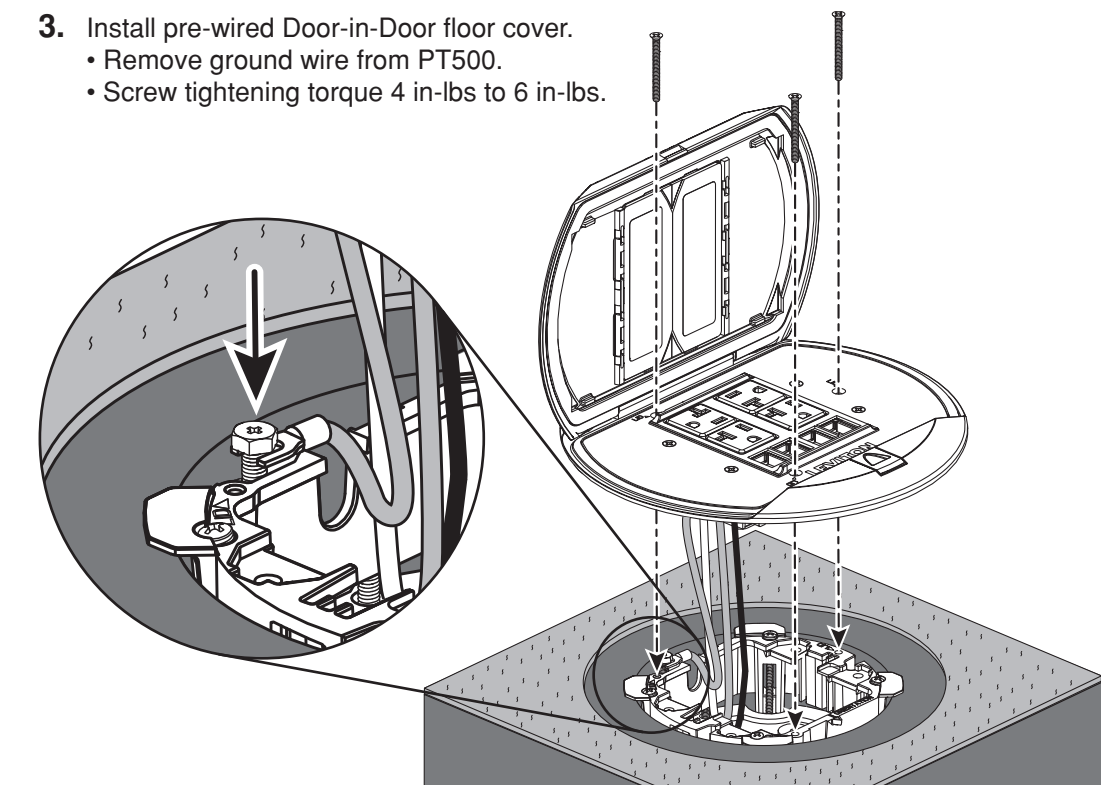

To remove/replace data ports:

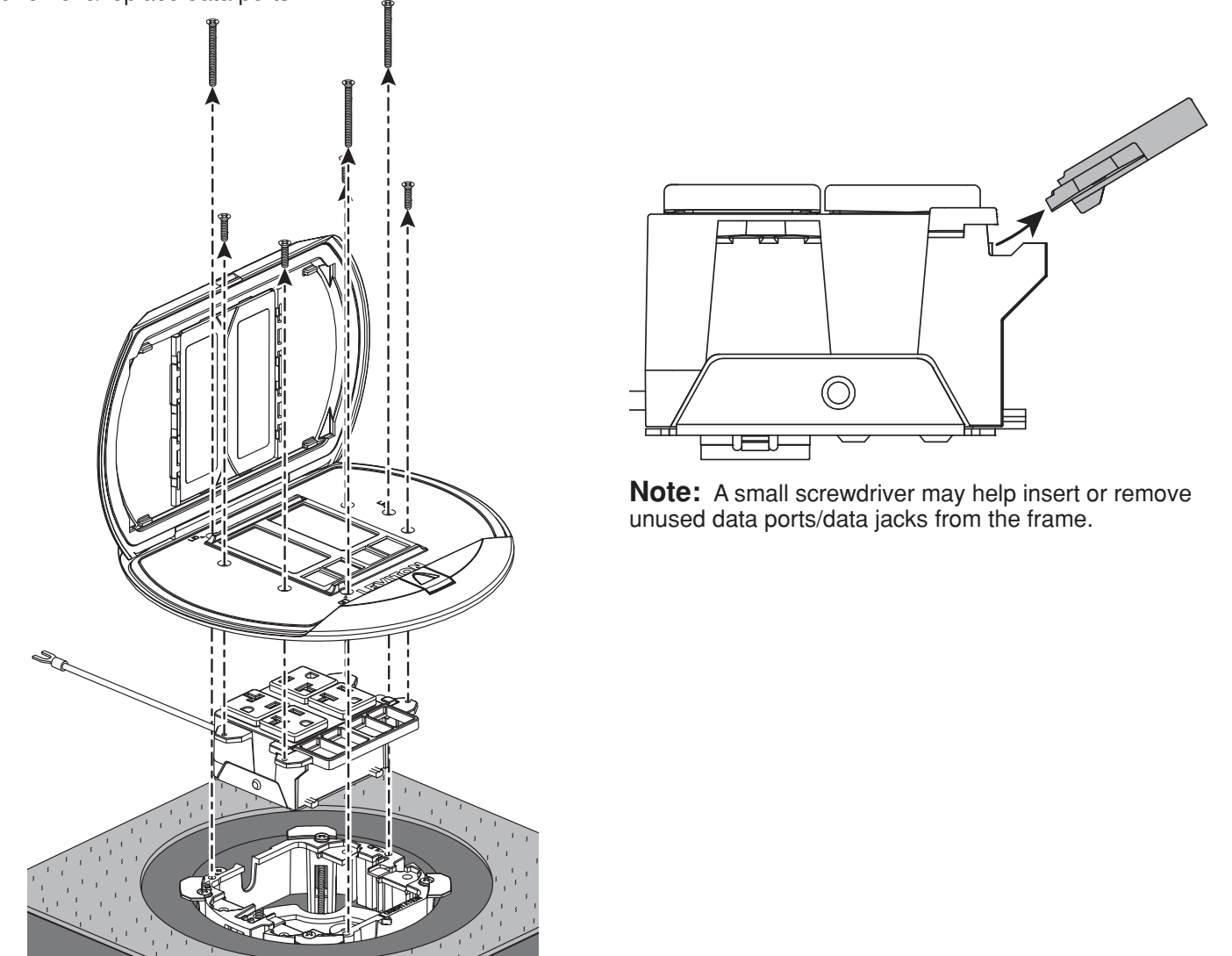

Note: A small screwdriver may help insert or remove unused data ports/data jacks from the frame.